

**CultureWell™ Chambered Coverglass
for Cell Culture (C-37000)**

1. Cell culture may be performed using conventional methods.
2. Gently decant media.
3. Insert the slip separator string between gasket tabs as shown. Pull slip separator along the length of the assembly to separate silicone coverglass gasket and chambered well gasket.
4. Gently remove coverglass with attached gasket.
5. Small volume incubation may be performed using the wells formed by the silicone gasket.
6. Aqueous mounting of specimens may be performed with wells in place, by filling wells with media and pressing a coverglass or microscope slide to the gasket surface.
7. To remove the silicone gasket from the coverglass, peel slowly at a sharp angle to the glass.
8. For specimen mounting, match the less rounded corner of the coverglass to location feature (H) on the blue frosted edge of the microscope slide (provided). Refer to orientation key below.

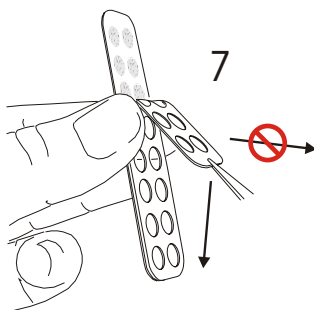
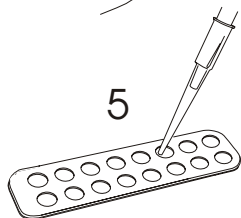
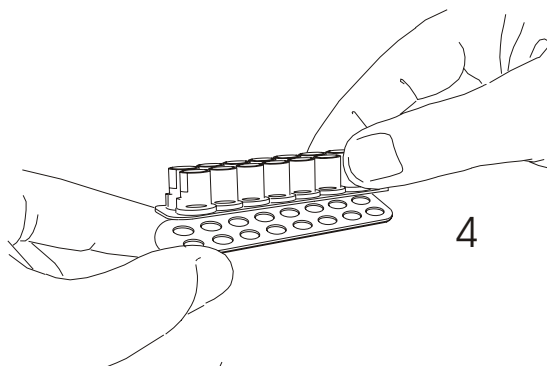
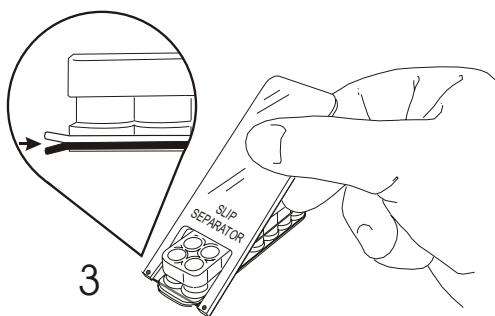
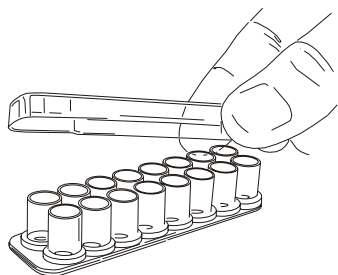
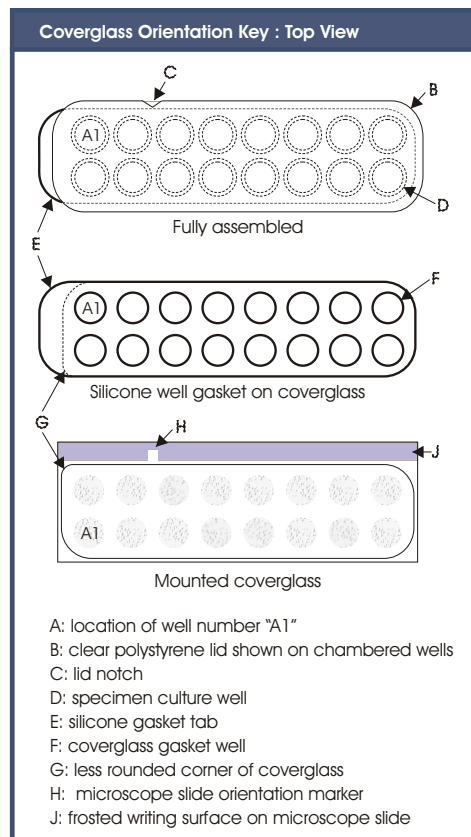

**GRACE
BIO-LABS**

Product List *Current prices may be obtained from our Web site or from our Customer Service Department.*

Cat #	Product Name	Unit Size
C-37000	CultureWell™ chambered coverglass for cell culture *sixteen wells per coverglass* *set of 8*	1 set

Contact Information

Further information on Molecular Probes' products, including product bibliographies, is available from your local distributor or directly from Molecular Probes. Customers in Europe, Africa and the Middle East should contact our office in Leiden, the Netherlands. All others should contact our Technical Assistance Department in Eugene, Oregon.

Please visit our Web site — www.probes.com — for the most up-to-date information.

Molecular Probes, Inc.

29851 Willow Creek Road, Eugene, OR 97402
Phone: (541) 465-8300 • Fax: (541) 335-0504

Customer Service: 6:00 am to 4:30 pm (Pacific Time)
Phone: (541) 335-0338 • Fax: (541) 335-0305 • order@probes.com

Toll-Free Ordering for USA and Canada:
Order Phone: (800) 438-2209 • Order Fax: (800) 438-0228

Technical Assistance: 8:00 am to 4:00 pm (Pacific Time)
Phone: (541) 335-0353 • Fax: (541) 335-0238 • tech@probes.com

Molecular Probes Europe BV

Poortgebouw, Rijnsburgerweg 10
2333 AA Leiden, The Netherlands
Phone: +31-71-5233378 • Fax: +31-71-5233419

Customer Service: 9:00 to 16:30 (Central European Time)
Phone: +31-71-5236850 • Fax: +31-71-5233419
eurorder@probes.nl

Technical Assistance: 9:00 to 16:30 (Central European Time)
Phone: +31-71-5233431 • Fax: +31-71-5241883
eurotech@probes.nl

Molecular Probes' products are high-quality reagents and materials intended for research purposes only. These products must be used by, or directly under the supervision of, a technically qualified individual experienced in handling potentially hazardous chemicals. Please read the Material Safety Data Sheet provided for each product; other regulatory considerations may apply.

Several of Molecular Probes' products and product applications are covered by U.S. and foreign patents and patents pending. Our products are not available for resale or other commercial uses without a specific agreement from Molecular Probes, Inc. We welcome inquiries about licensing the use of our dyes, trademarks or technologies. Please submit inquiries by e-mail to busdev@probes.com. All names containing the designation ® are registered with the U.S. Patent and Trademark Office.

Copyright 2003, Molecular Probes, Inc. All rights reserved. This information is subject to change without notice.